

## TPLUS 26

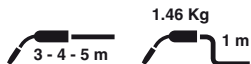

V peak	113	Ø mm	0.8 - 0.9 1.0 - 1.2	X	290A CO <sub>2</sub> 260A Mix
--------	-----	------	------------------------	---	----------------------------------

CODE	↔	⚡
MA3323	3 m	EURO
MA3324	4 m	EURO
MA3325	5 m	EURO

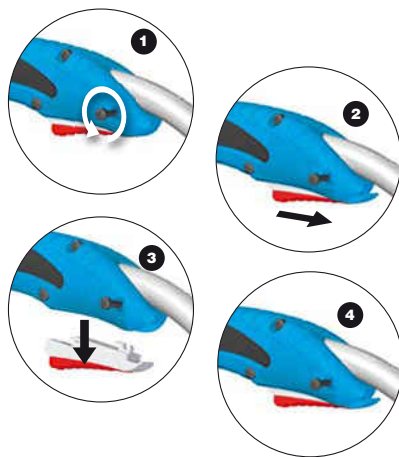

- IT** Sostituzione rapida del pulsante
- EN** Quick Trigger Replacement
- DE** Schnellwechselsystem für den Schalter
- FR** Remplacement rapide de la gâchette
- ES** Sustitucion rápida del pulsador
- TR** Kolay ve çabuk tetik değişimi.
- RU** Быстрая замена курка



EURO



EN 60974-7



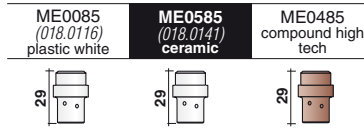

Ø mm	Ø in	Cu	Cu-Ni	Cu for Al	CuCrZr	Triangular Cu
0,6	.023	MD0009-06 (140.0005)	MD0009-36		MD0009-76	-
0,8	.030	MD0009-08 (140.0051)	MD0009-38	MD0009-58 (141.0001)	MD0009-78 (140.0054)	MD1009-08
0,9	.035	MD0009-09 (140.0169)				
1,0	.040	<b>MD0009-10 (140.0242)</b>	MD0009-40	MD0009-60 (141.0006)	MD0009-80 (140.0245)	MD1009-10
1,2	.045	MD0009-12 (140.0379)	MD0009-42	MD0009-62 (141.0010)	MD0009-82 (140.0382)	MD1009-12
1,4	.052	MD0009-14	MD0009-44		MD0009-84	-
1,6	1/16	MD0009-16 (140.0555)	MD0009-46	MD0009-66	MD0009-86	-



Ø mm	Ø in	Cu	Cu-Ni	Cu for Al	CuCrZr	Triangular Cu	Triangular CuCrZr
0,8	.030	MD0005-08 (140.0114)	MD0005-38	MD0005-58 (141.0003)	MD0005-78	-	
0,9	.035	MD0005-09	MD0005-39	MD0005-59			
1,0	.040	MD0005-10 (140.0313)	MD0005-40	MD0005-60 (141.0008)	MD0005-80 (140.0316)	MD1005-10	MD1005-80
1,2	.045	MD0005-12 (140.0442)	MD0005-42	MD0005-62 (141.0015)	MD0005-82 (140.0445)	MD1005-12	MD1005-82
1,4	.052	MD0005-14	MD0005-44		MD0005-84	-	
1,6	1/16	MD0005-16 (140.0587)	MD0005-46	MD0005-66 (141.0022)	MD0005-86 (140.0590)	MD1005-16	MD1005-86
2,0	5/64	MD0005-20 (140.0653)		MD0005-70	MD0005-90	-	
2,4	3/32	MD0005-24 (140.0677)		MD0005-74	MD0005-94	-	



MC0290 (145.0132)	MC0292	MC0268 (145.0085)	MC0276 light	<b>MC0568</b> quick release	MC0576 light quick release	MC0340 heavy duty	MC0291 (145.0051)	MC0293 (145.0179)
-------------------	--------	-------------------	--------------	-----------------------------	----------------------------	-------------------	-------------------	-------------------

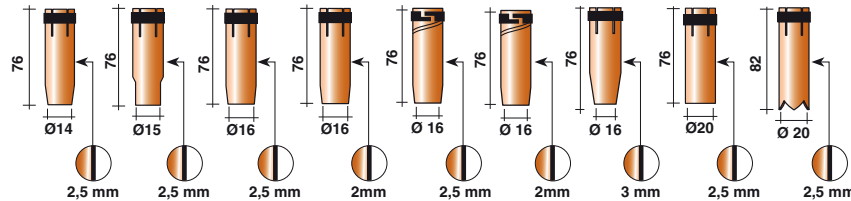

STANDARD

(REF.)

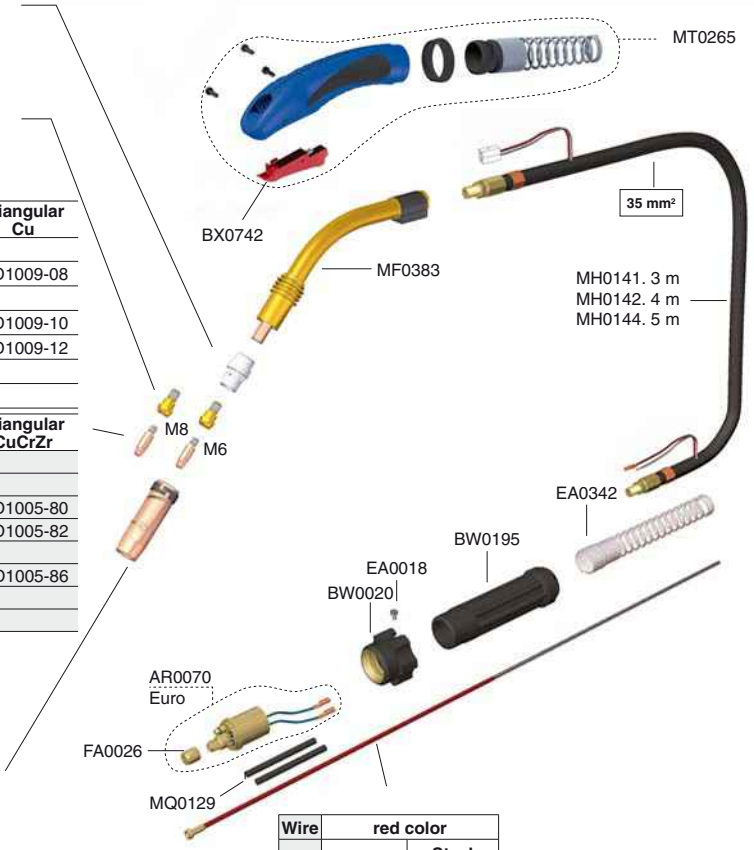

Wire	red color	
		Steel
1,0 ± 1,2 .040" ± .045"	3 m / 10'	<b>GM0510</b> (124.0026)
	4 m / 12'	<b>GM0511</b> (124.0031)
	5 m / 16,4'	<b>GM0512</b> (124.0035)